

I hereby certify that this plan, specification or report was prepared by me or under my direct supervision and that I am a duly Licensed Architect under the laws of the State of Minnesota.
Edward A. Farr

Date _____ Reg. No. 16362
Project Manager
XXX
© 2009-2009

NEW SIDEWALK TO BE CONSTRUCTED AS PART OF PHASE I HOTEL DEV. FOR CONTINUITY TO NORMANDALE LAKE BLVD. SIDEWALK.

RIGHT IN/RIGHT OUT CURB CUT RELOCATED APPROX. 30' EAST WHENEVER AMER. BLVD. IMPROVED. NO LATER THAN DURING PHASE II OFFICE DEVELOPMENT. MAINTAIN FULL-ACCESS CURBCUT DURING PHASE I HOTEL DEVELOPMENT

EXISTING AMERICAN BLVD. STREET R.O.W. ALIGNMENT

AMERICAN BOULEVARD WEST (IMPROVED)

GREEN VALLEY ROAD

EXIST. RESIDENTIAL DEVELOPMENT

EXIST. SIDEWALK (SHOWN DOTTED) TO REMAIN UNTIL OFFICE DEVELOPMENT RELOCATES NEW SIDEWALK INTO EASEMENT

EXIST. CURB CUT

EXISTING 8500 PARKING DECK

NORMANDALE LAKE BLVD.

NORMAN CENTER DRIVE

W. 83RD ST.

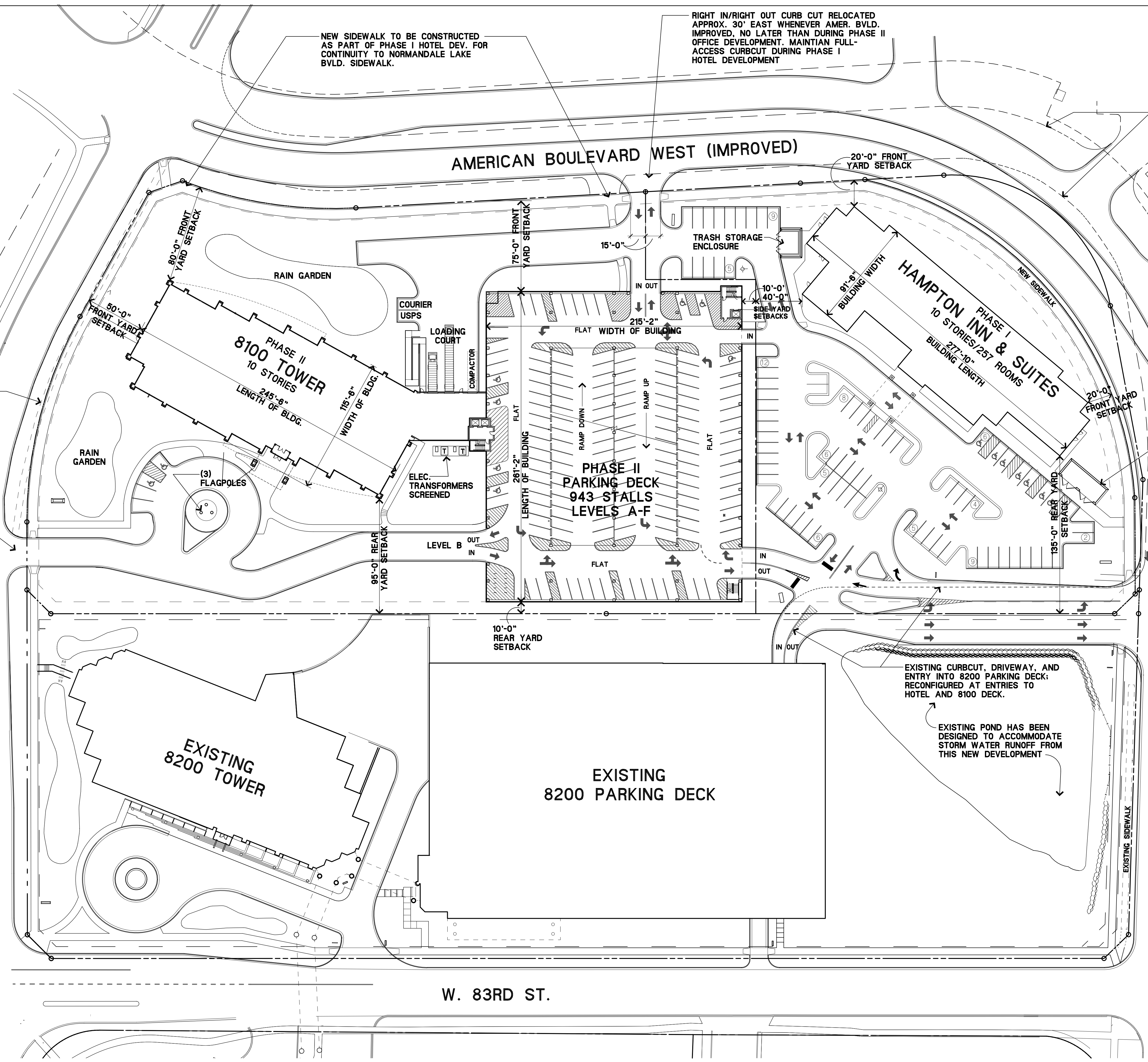

EDWARD FARR ARCHITECTS INC

7710 Golden Triangle Dr. Tel: 952-943-9660
Eden Prairie, Minnesota Fax: 952-943-9665
55344 www.edfarrarch.com

Client
UNITED PROPERTIES

Project
NORMANDALE LAKE OFFICE PARK / 8100 TOWER AND HOTEL P.U.D. PRELIMINARY DEVELOPMENT PLAN

Location
AMERICAN BOULEVARD WEST AND NORMANDALE LAKE BOULEVARD BLOOMINGTON, MINNESOTA

Issued For Date
DBE SUBMITTAL 03/29/2009

Sheet Title
SITE PLAN

Project Number Sheet Number
07.061 A1.1

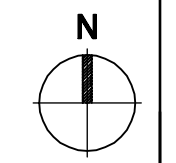

0 20 40 80

f:_cad\dl\op.pj\07061.dwg_spr_a1-1.sht 4/29/2009-10:40

1 8100 OFFICE BUILDING AND HOTEL SITE PLAN
A1.1 SCALE: 1"=40'-0"